

PRO  
SERIES

**SIMRAD**

# SI80 NMEA 0183 INTERFACE, INSTALLATION GUIDE

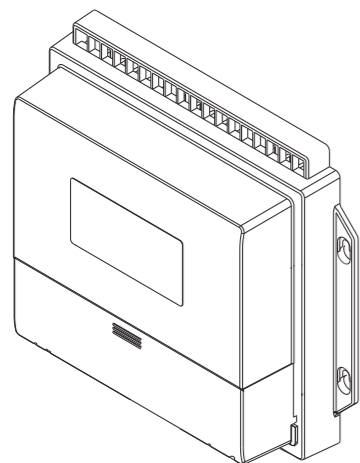

## Parts included

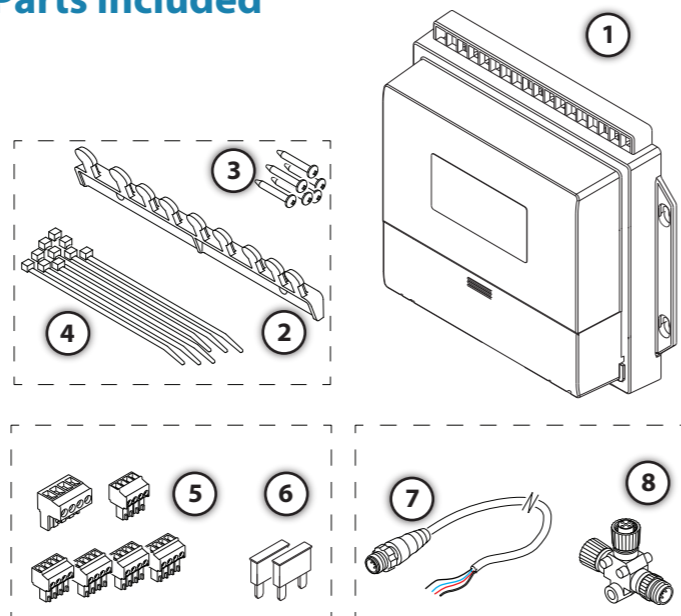

- 1 1 \* SI80 Computer
- 2 1 \* Cable retainer
- 3 6 \* Fixing screws, 3.5 \* 19 mm (DIN7981B)
- 4 10 \* Strips
- 5 6 \* Connectors
- 6 2 \* 7.5 Amp Fuse
- 7 1 \* Micro-C Drop cable (male)
- 8 1 \* Micro-C T-Joiner

## Dimensions

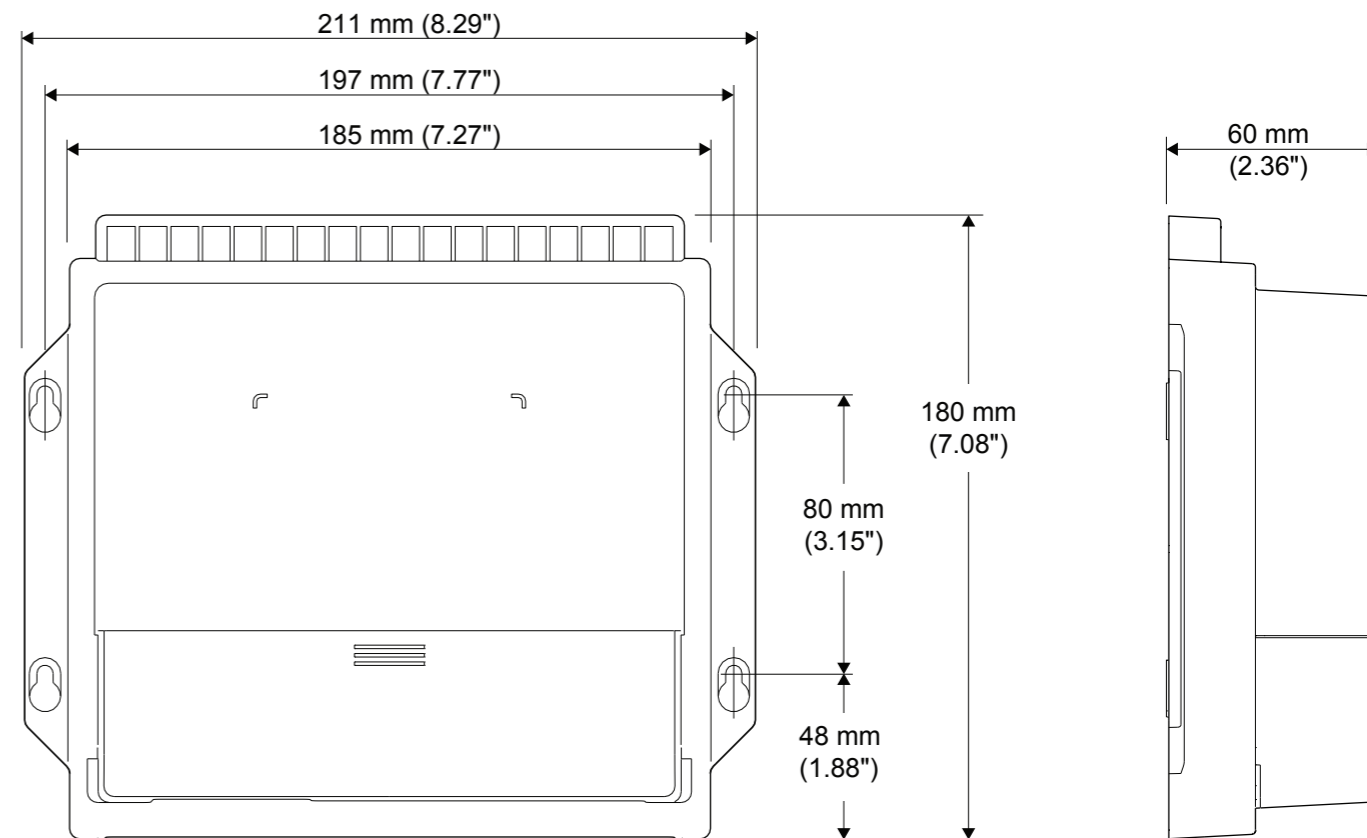

For technical specifications,  
certificates and declarations,  
refer to the product web site on:



pro.simrad-yachting.com



www.simrad-yachting.com



## Mounting

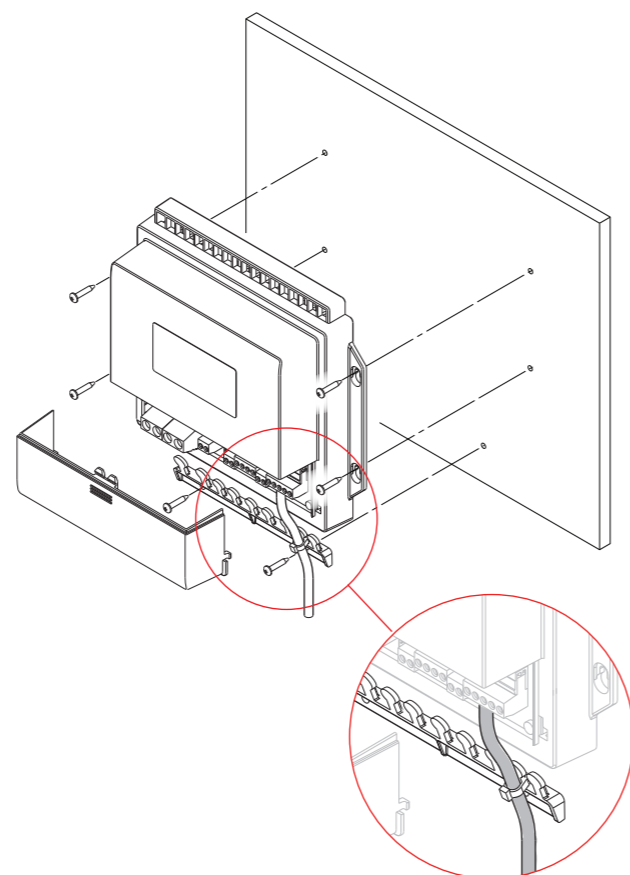

## System wiring

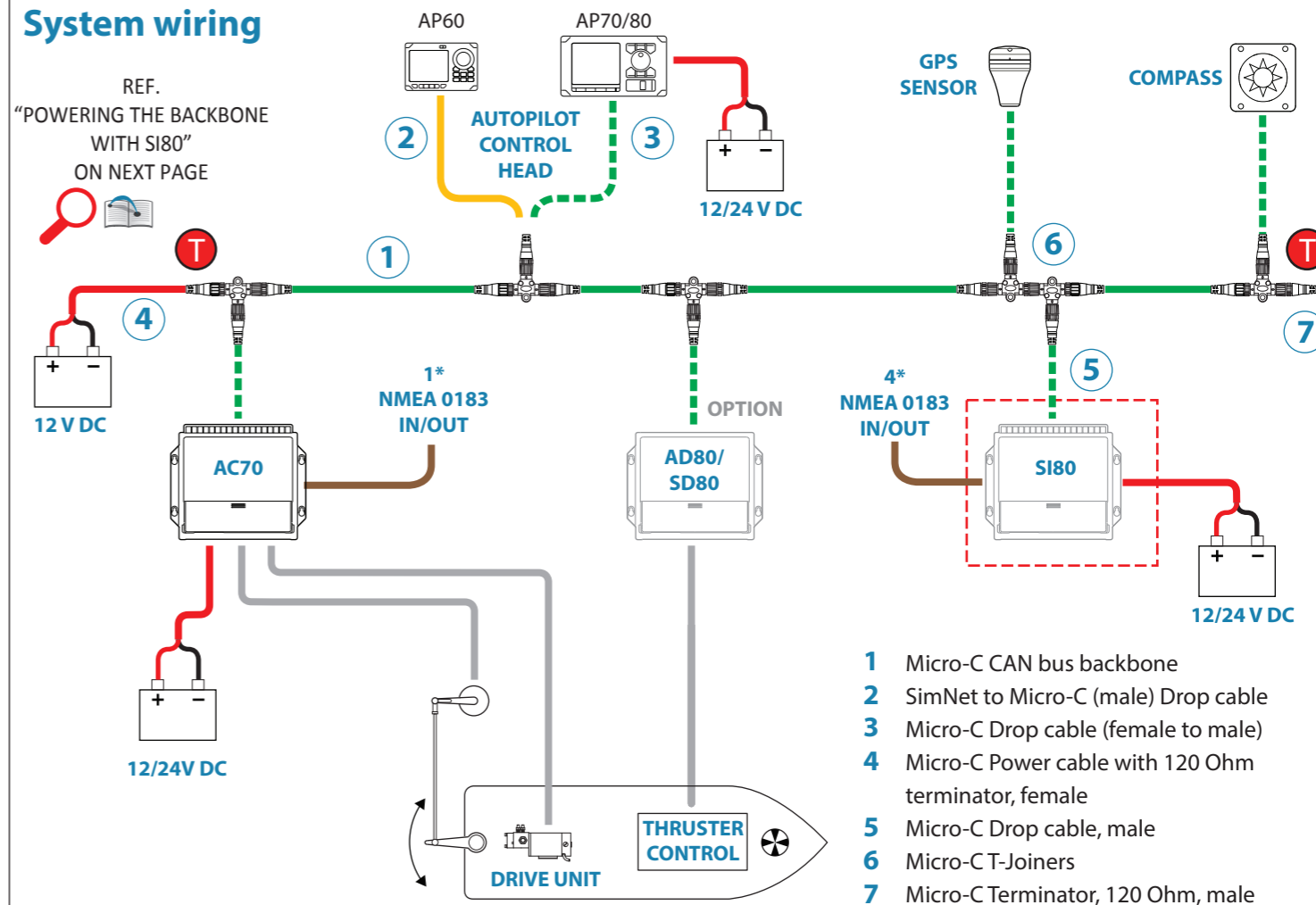

## SI80 Terminal layout

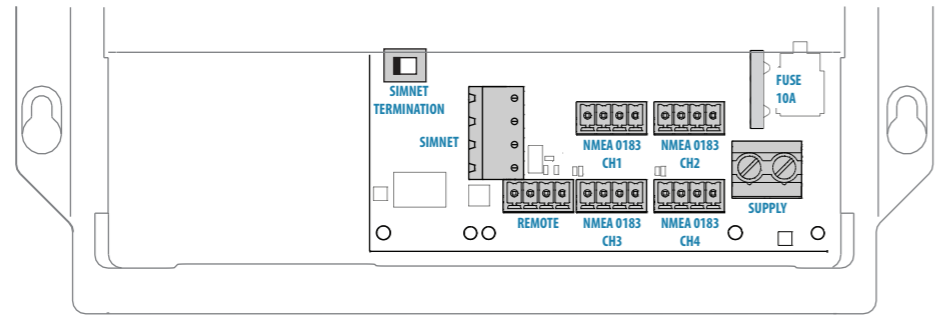

## Powering the CAN bus backbone with SI80

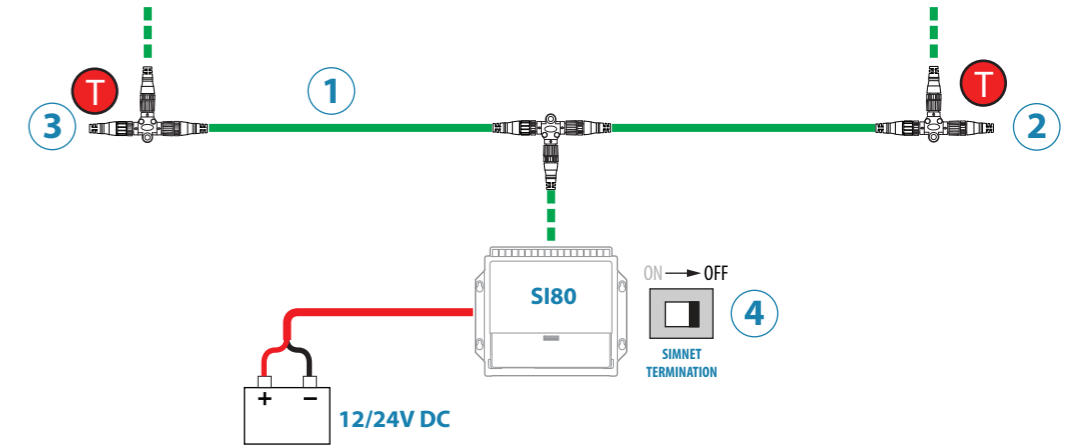
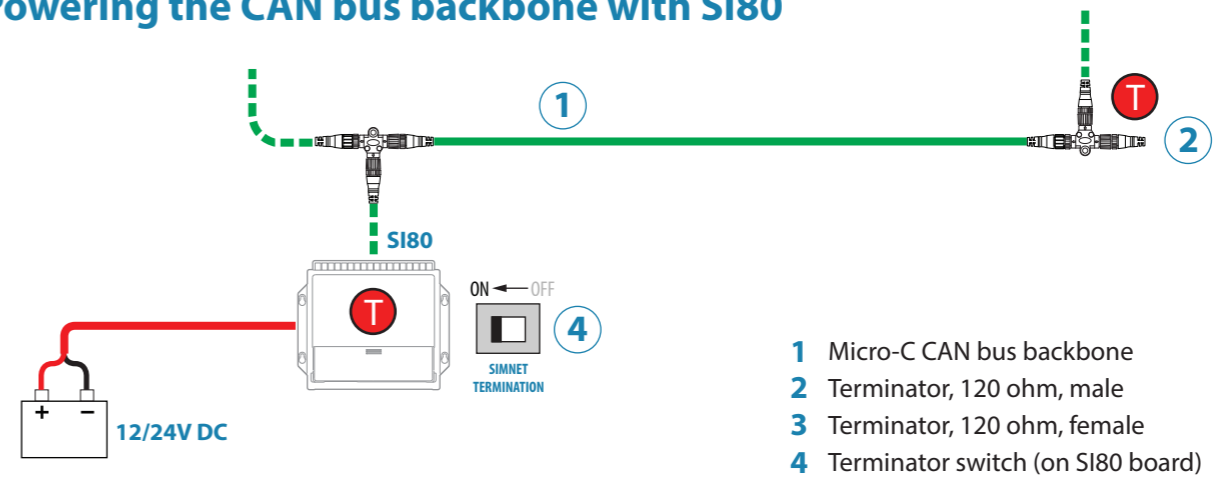

## CAN Bus backbone

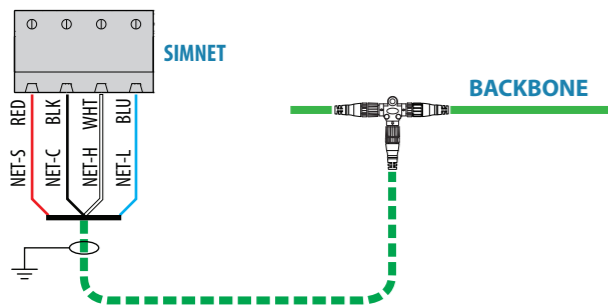

## NMEA 0183 devices

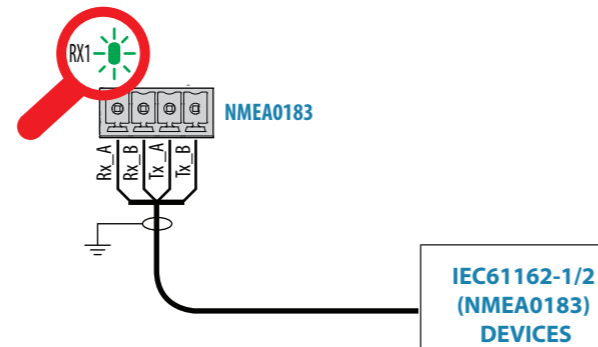

## Power supply

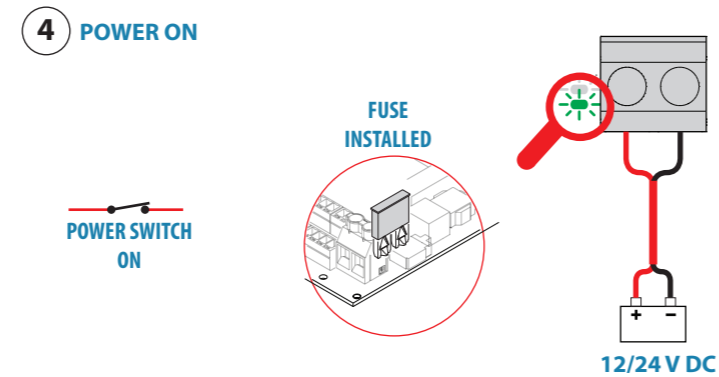
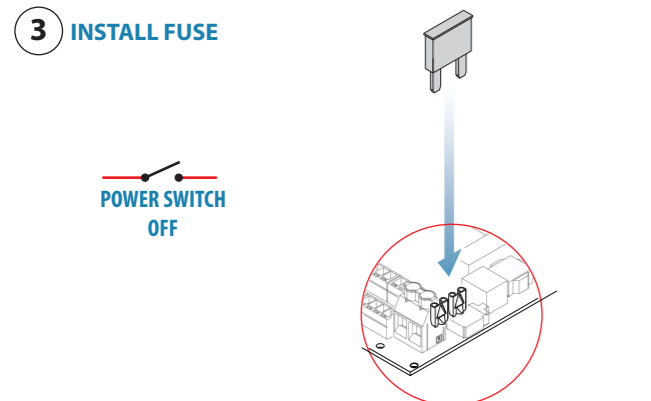
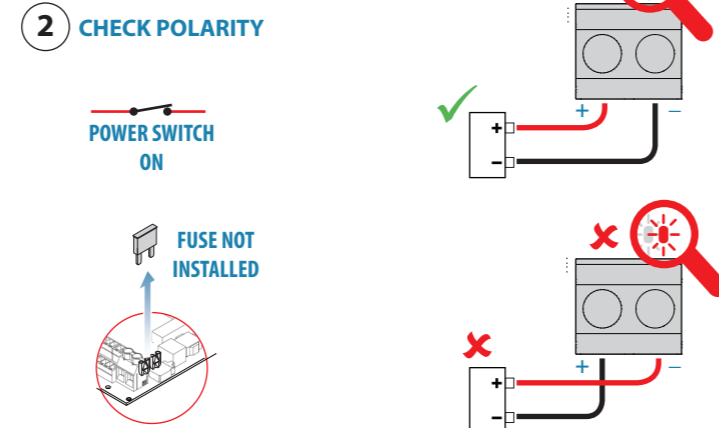
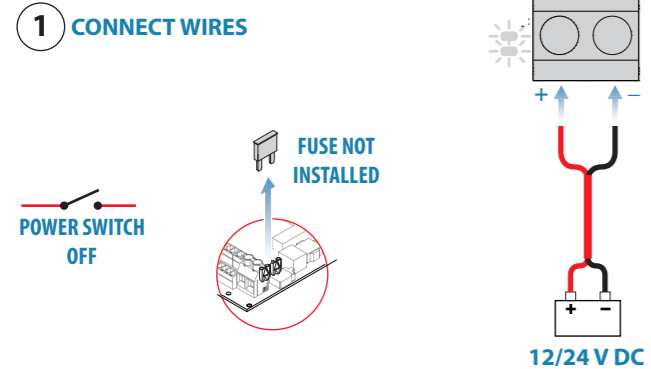

## Notes

The SI80 power supply complies with NMEA2000 specifications. Always power the CAN bus backbone from SI80/SI80 board when SI80 is part of the autopilot system.

Set Terminator switch to ON when the SI80 is at the end of the backbone, otherwise to OFF. Factory default is OFF.

If joining to an existing NMEA2000 network or similar CAN bus network that has its own power supply, use an NMEA2000 Gateway to isolate the two power supplies

L'alimentation du SI80 est conforme à la norme NMEA2000. L'alimentation du backbone du bus CAN se fait à partir du SI80 lorsque celui-ci fait partie du système pilote automatique.

Positionner le switch Terminator sur ON lorsque le SI80 se trouve à une extrémité du backbone, dans le cas contraire le positionner sur OFF. La position par défaut du switch est OFF.

Si le SI80 s'intègre dans un réseau NMEA2000 ou un bus CAN équivalent possédant sa propre alimentation, utiliser un Gateway NMEA2000 pour isoler les deux alimentations.

Die SI80 Stromversorgung entspricht den NMEA2000 Spezifikationen. Verwenden Sie immer die SI80/SI80 Stromversorgung für den CAN BUS, wenn das SI80 Bestandteil des Autopilot-Systems ist.

Stellen Sie den Abschlusswiderstandsschalter auf AN wenn das SI80 am Ende des „Backbones“ ist, sonst auf AUS. Voreingestellt ist AUS.

Wenn es an ein bestehendes NMEA2000 oder ähnliches CAN Bus Netzwerk mit eigener Stromversorgung angeschlossen wird, nutzen Sie bitte ein NMEA2000 Gateway um die beiden Stromversorgungen zu trennen.

SI80 strømforsyningen er i overensstemmelse med NMEA2000 spesifikasjonene. Forsyn (derfor) alltid CAN nettverket fra SI80/SI80 kort når SI80 er en del av autopilot systemet.

Sett termineringsbryteren i stilling ON når SI80 står i enden av nettverket, ellers til OFF. Fabrikkinnstilling er OFF.

Ved sammenkobling med annet NMEA2000 nettverk eller tilsvarende CAN nettverk som har sin egen strømforsyning må det installeres en NMEA2000 Gateway for å isolere de to strømforsyningene fra hverandre.

## Steering Levers

OPTION

